



**5 Gowrie Mountain School Road Kingsthorpe QLD**

**4** **2** **5**

**The Details**

- Four huge bedrooms
- Master with WIR, ensuite and slider to front verandah
- Spacious lounge room plus a rumpus
- Large u-shape kitchen with dining adjacent
- Air-conditioning, ceiling fans and a wood heater
- Private, covered outdoor alfresco
- 6m x 7.5m powered shed, 6.5m x 8m powered shed, and 4m x 7.5m carport
- An abundance of rainwater storage plus a bore
- 1,379sqm secure allotment

**Make it Yours**

Deceptively large, this beautiful family home sits perfectly on its lush lawn and from the street only gives you a

**Land Size** : 1379 sqm  
**View** : <https://www.jenkinsrealestate.com.au/sale/qld/toowoomba-district/kingsthorpe/residential/house/7834364>



**Scott Jenkins**  
**0424 807 302**

5 GOWRIE MOUNTAIN SCHOOL ROAD, KINGSTHORPE



FOUR



TWO



FIVE



1379 m<sup>2</sup>

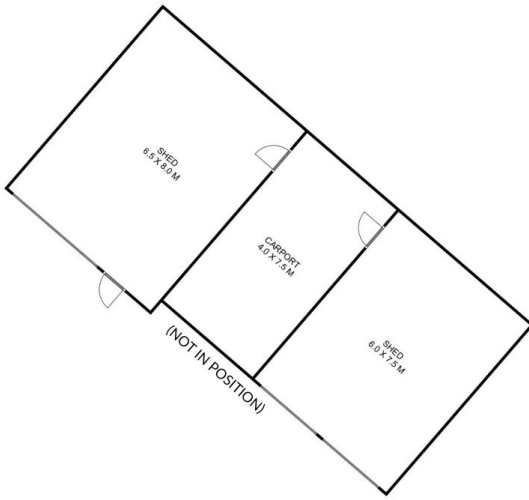

This plan is for representational purposes only. All dimensions displayed are approximate and shouldn't be solely relied upon. Do not edit, reproduce, copy, modify, crop or in any way exploit copyright to Statik Illusions. More info : [statikillusions.com/usage-rights/](http://statikillusions.com/usage-rights/)